

INTERIOR TABLE/SEAT CALCULATION			
ITEM	DESCRIPTION	FURNITURE QUANTITY	SEATING QUANTITY
80	BAR STOOL	5	5
82	2 TOP TABLE - 24X48	2	4
82HC	4 TOP ADA TABLE - 30X48	2	8
85	BOOTH - 30X48	4	16
85A	BOOTH - 30X60	5	25
TOTAL		18	58

*THIS SEATING ARRANGEMENT ACCOMMODATES 18 TABLES

EXTERIOR TABLE/SEAT CALCULATION			
ITEM	DESCRIPTION	FURNITURE QUANTITY	SEATING QUANTITY
87	OUTDOOR - 30X48	2	8
87HC	OUTDOOR - 30X48 - ADA	1	4
87A	OUTDOOR - 36" ROUND TABLE	3	12
87AHC	OUTDOOR - 36" ROUND ADA	1	4
TOTAL		7	28

*THIS SEATING ARRANGEMENT ACCOMMODATES 7 TABLES

CONSTRUCTION NOTES

- PVC CHASE BY G.C. FOR SODA LINES - COORDINATE WITH SODA VENDER
- SURFACE MOUNTED FIRE EXTINGUISHER / FIRE EXTINGUISHER CABINET IN THE DINING - SEE DETAIL 5/502.
- WALK-IN COOLER / FREEZER w/INTEGRAL CONDENSERS MOUNTED ON UNIT.
- LOW VOLTAGE CONDUIT TO EQUIPMENT FOR LOW VOLTAGE SYSTEM - G.C. TO INSTALL - COORDINATE W/EQUIPMENT SUPPLIER
- INSULATED FLOOR / SLAB - BY EQUIPMENT VENDOR
- HAND SINK - SEE PLUMBING DRAWINGS
- 4"x4" SQ. CHASE FOR OIL SYSTEM INSTALLED BY GC - SEE DET. 4/A502 - COORDINATE W/EQUIPMENT SUPPLIER.
- PROVIDE 1 1/4" BLACK IRON PIPE UP THROUGH WALLS / CEILING FOR WASTE OIL RECOVERY SYSTEM
- CONNECTION FOR GREASE / OIL WASTE
- SHELVING DESK TO HAVE SOLID S.S. TOP AT 34" A.F.F. WITH SHELVES ABOVE DESK - EXACT SPEC BY THE TENANT.
- 4"x4" SQ. CHASE FOR OIL SYSTEM INSTALLED BY GC - SEE DET. 8/A502 - COORDINATE W/EQUIPMENT SUPPLIER.
- SODA SYSTEM SYRUP LINE BUNDLE - ROUTING ABOVE CEILING DOWN WALLS TO SODA MACHINES.
- OPTIONAL EQUIPMENT - G.C. TO VERIFY/COORDINATE FINAL EQUIPMENT PACKAGE PRIOR TO INSTALLING UTILITIES OR CONNECTING EQUIPMENT
- TRENCH DRAIN BY P.C. - SEE PLUMBING SHEETS.

GENERAL NOTES

- ALL FURNITURE TO BE SELECTED AND PROVIDED BY OWNER - COORDINATE WITH EQUIPMENT SCHEDULE
- G.C. TO COORDINATE ALL CLEARANCES REQUIRED FOR EQUIPMENT AND MILLWORK WITH EQUIPMENT SUPPLIER.
- ALL CABINETS / COUNTERTOPS ARE INCLUDED IN THE EQUIPMENT PACKAGE. GC ONLY TO COORDINATE FIELD DIMENSIONS WITH SUPPLIER.
- VERIFY ALL SHELVING AND WORK TABLES QUANTITIES WITH OWNER.
- REFER TO SHEET Q600 FOR EQUIPMENT SCHEDULING - G.C. TO VERIFY/COORDINATE FINAL EQUIPMENT PACKAGE PRIOR TO INSTALLING UTILITIES OR CONNECTING EQUIPMENT.
- STAINLESS STEEL CORNER GUARD/END CAPS SHALL BE PROVIDED & INSTALLED ON ALL BACK OF THE HOUSE CORNERS AND END CAPS - SEE SHEET A111 FOR LOCATIONS.
- LOCATE REMOTE WALK-IN FREEZER/COOLER CONDENSER ON MAIN FLAT ROOF. SEE MECHANICAL DRAWINGS. G.C. COORDINATE POWER REQUIREMENTS AND PIPING W/ COOLER SUPPLIER AND INSTALLER.
- PATIO SEATING UMBRELLAS TO BE BLACK.

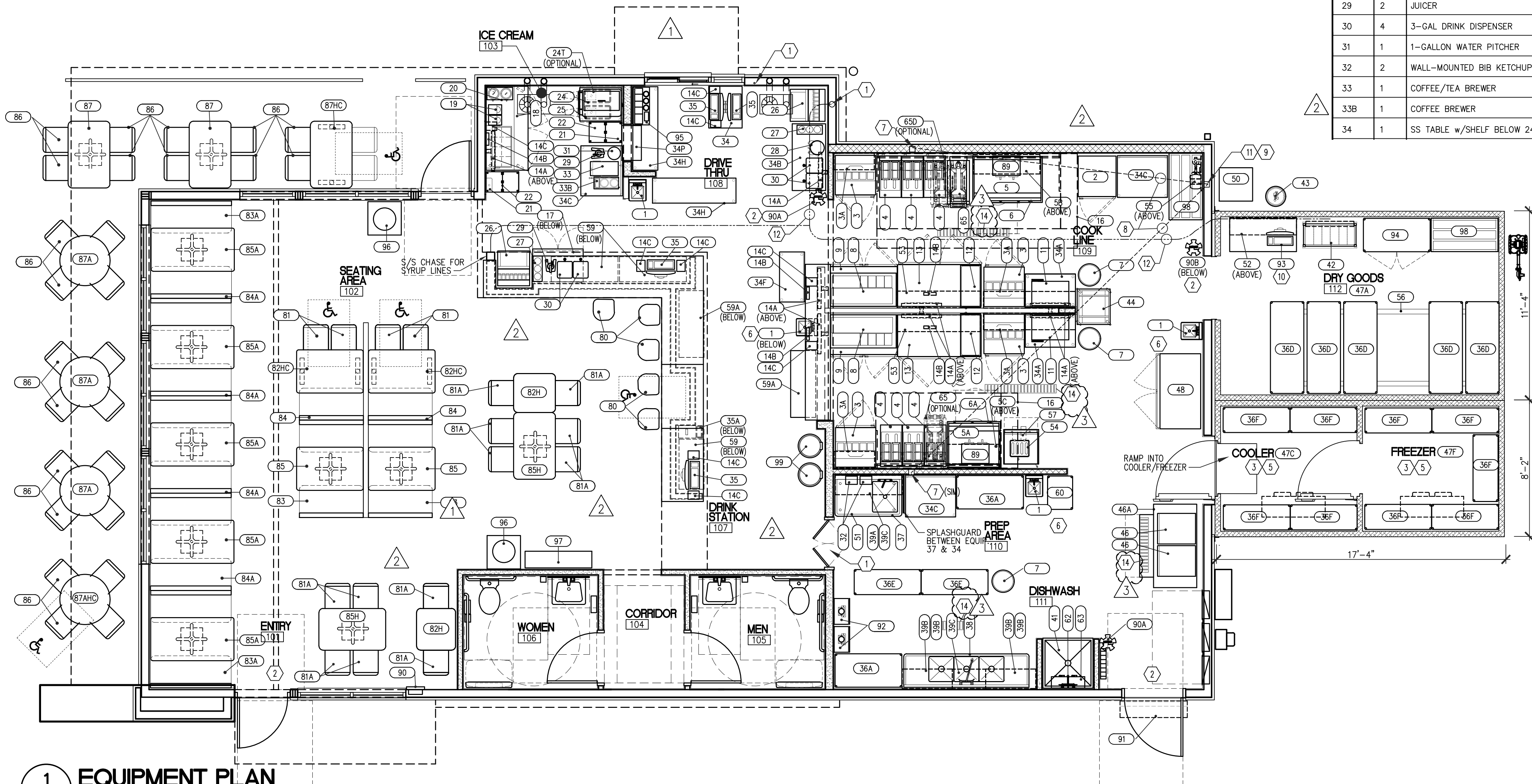

1
Q111 EQUIPMENT PLAN
SCALE: 1/4" = 1'-0"

ITEM	QTY.	DESCRIPTION	ITEM	QTY.	DESCRIPTION
1	4	HAND SINK w/2 SPLASHGUARDS	34A	2	SS TABLE W/ SHELF BELOW 24"x36"
2	1	1-DOOR FREEZER	34B	1	SS TABLE W/SHELF BELOW 24"x48"
3	4	REFRIG. PREPBOX - 29"W	34C	3	SS TABLE W/ SHELF BELOW 30"x36"
3A	4	24"W SHELVES	34F	1	SS TABLE W/SHELF BELOW 18"x36"
4	6	FRYER	34H	3	SS TABLE W/SHELF BELOW 18"x60"
5	1	GRIDDLE	34P	1	14"x 24" PASS-THRU SHELF
5A	1	GRIDDLE	35	4	POS TERMINAL SYSTEM
5B	1	WALL-MOUNTED WIRE SHELVES - 48"W	35A	1	DROP SAFE - UNDERCOUNTER
5C	1	WALL-MOUNTED WIRE SHELVES - 36"W	36A	2	STORAGE RACK - 24x48
6	1	REFRIG. CHEFBASE - 48"W	36D	5	STORAGE RACK - 24x72
6A	1	REFRIG. CHEFBASE - 36"W	36E	2	STORAGE RACK - 18x48
7	3	TRASH CAN	36F	9	F/C STORAGE RACK - 18x48
8	2	WARMING STATION	37	1	VEGGIE SINK W/ RH DRAIN
9	2	WORKTOP FREEZER	38	1	3-COMPARTMENT SINK
11	2	STEAMER	39A	1	WALL-MOUNTED WIRE SHELVES - 48"W
12	2	COOKER/WARMER	39B	4	WALL-MOUNTED WIRE SHELVES - 36"W
13	2	REFRIG. PREPBOX - 60"W	39C	2	WALL-MOUNTED WIRE SHELVES - 24"W
14A	7	MONITOR	41	1	CAN WASH
14B	5	BUMPBAR	42	1	MODULAR BIB RACK
14C	9	PRINTER	43	1	CO2 TANK
16	2	HOOD SYSTEM	44	1	BREAD RACK
17	1	REFRIG. PREPBOX - 36"W	46	2	ICE MACHINE W/ FLAKER HEAD
18	1	REFRIG. PREPBOX	46A	1	ICE BIN - 1500LB
19	2	MIX-IN BLENDER	47A	1	OUTSIDE WALK-IN DRY STORAGE
20	1	COOKER/WARMER	47C	1	OUTSIDE WALK-IN COOLER (BUILT w/#47F)
21	2	DIPPER WELL	47F	1	OUTSIDE WALK-IN FREEZER (BUILT w/#47C)
22	2	DIPPING CABINET	48	1	2-DOOR COOLER
24	1	FROZEN CUSTARD MACHINE	50	1	USED OIL CONTAINER
24T	1	OPTIONAL FROZEN CUSTARD MACHINE	51	1	CAN OPENER
25	1	EQUIPMENT STAND	52	1	EMPLOYEE CUBBIES
26	2	SODA MACHINE	53	2	SHELF 48"W X 12"D - MNTD TO #9
27	2	CUP DISPENSER	54	1	TOASTER - 4 SLOT
28	1	ELEC. JUICE DISPENSER	55	1	WATER FILTRATION SYS. w/BOOSTER PUMP
29	2	JUICER	56	1	MOVABLE RACK SYSTEM
30	4	3-GAL DRINK DISPENSER	57	1	CONVECTION OVEN
31	1	1-GALLON WATER PITCHER	59	3	HALF HEIGHT STORAGE RACK - 18x36
32	2	WALL-MOUNTED BIB KETCHUP DISPENSER	59A	2	HALF HEIGHT STORAGE RACK - 18x48
33	1	COFFEE/TEA BREWER	60	1	BISCUIT RACK
33B	1	COFFEE BREWER	62	1	SERVICE SINK FAUCET
34	1	SS TABLE w/SHELF BELOW 24"x30"	63	1	UTILITY SHELF MOP RACK

65	2	ELECTRIC 12" CLAMSHELL GRILL
65D	1	OPTIONAL ELECTRIC 24" CLAMSHELL GRILL
80	5	BAR STOOL
81	4	DINING CHAIRS
81A	12	HI-TOP CHAIRS
82H	2	2 SEAT HI-TOP TABLE
82HC	2	ADA TABLE - 30"x48"
83	2	BOOTH BENCH 48" - END
83A	2	BOOTH BENCH 60" - END
84	2	BOOTH BENCH 48" - DOUBLE
84A	4	BOOTH BENCH 60" - DOUBLE
85	2	BOOTH TABLE - 30"x48"
85A	5	BOOTH TABLE - 30"x60"
85H	2	4 SEAT HI-TOP TABLE - 30"x48"
86	26	OUTDOOR CHAIRS
87	2	OUTDOOR TABLE 30"x48"
87A	3	OUTDOOR TABLE 36" ROUND
87AHC	1	OUTDOOR TABLE 36" ROUND ADA
87HC	1	OUTDOOR TABLE 30"x48" - ADA
89	2	DEDICATED HOLDING CABINET
90	1	SEMI RECESSED FIRE EXTINGUISHER
90A	2	FIRE EXTINGUISHER
90B	1	FIRE EXTINGUISHER
91	1	AIR CURTAIN
92	2	INSTANTANEOUS WATER HEATER PACKAGE
93	1	MANAGERS DESK/ SHELVING UNIT
94	1	IT EQUIPMENT SHELVING UNIT
95	1	WALL MOUNTED CONDIMENTS
96	2	PUBLIC TRASH BIN
97	1	TO GO RACK
98	2	DUNNAGE RACK - 24x48
99	2	SERVI ROBOT

LMHT Project No. 21318

THIS DRAWING IS THE PROPERTY OF THE ARCHITECT AND MAY NOT BE REPRODUCED OR USED WITHOUT THE WRITTEN PERMISSION.

national restaurant designers

ARCHITECTS & ENGINEERS

7208 ACC Blvd. second floor, Raleigh, NC 27617
ph: 919 544 0087 fax: 919 544 9399

A Division of LMHT Associates

BRIAN L. JONES

REGISTERED ARCHITECT

No.9372

NORTH CAROLINA

11/11/22

PROJECT: **HIGHWAY 55**
30 PROTOTYPE
1424 CURTIS BRIDGE ROAD
WILKESBORO, NC 28697

DRAWING: EQUIPMENT PLAN

Revisions

THRU ADDENDUM "A"	"A"
01/20/2022	
ADDENDUM "A" - 4.26.2022	
EQUIP. UPDATE - 06.24.2022	
CLARIFICATIONS - 11.11.2022	

PROJECT DATE
01/07/2022

Drawn By
MTP

Checked By
NRD

Sheet No.
Q111

NEW KITCHEN EQUIPMENT SCHEDULE																				
GENERAL								ELECTRICAL				PLUMBING								
ITEM	QTY.	DESCRIPTION	MANUFACTURER	SIZE/MODEL NUMBER	FURN. BY	INST. BY	CONN. BY	VOLT	PHASE	AMPS	HP	ROUGH-IN HEIGHT	CW	HW (110°)	HW (140°)	SUPPLY PIPING ROUGH-IN HEIGHT	DRAIN SIZE	DRAIN PIPING ROUGH-IN HT.	GAS/BTU	REMARKS
1	4	HAND SINK w/2 SPLASHGUARDS	SERV-WARE	HS10S-CWP	TENANT	GC	PC						1/2"	1/2"			1 1/2"			FAUCET INCLUDED WITH FIXTURE
2	1	1-DOOR FREEZER	HOSHIZAKI	EF1A	TENANT	GC	EC	115	1	3.2	1/3									NEMA 5-15P
3	4	REFRIG. PREPBOX - 29"W	SERV-WARE	SP 29-08-HC	TENANT	GC	EC	115	1	7	1/5									NEMA 5-15P
3A	4	24"W SHELVES		24" W	TENANT	GC														VERIFY MODEL W/ OWNER
4	6	FRYER	SERV-WARE	SGF-50N	TENANT	GC	PC												3/4" NPT - 120,000 BTU/HR (EA.)	
5	1	GRIDDLE	ROYAL	RTG-48	TENANT.	GC	PC												3/4" NPT - 120,000 BTU/HR (EA.)	REAR GAS CONNECTION & REGULATOR
5A	1	GRIDDLE	ROYAL	RTG-36	TENANT.	GC	PC												3/4" NPT - 90,000 BTU/HR (EA.)	REAR GAS CONNECTION & REGULATOR
5B	1	WALL-MOUNTED WIRE SHELVES - 48"W	SERV-WARE	14 INCHES DEEP x 48 INCHES WIDE	TENANT	GC														SEE PLANS AND INTERIOR ELEVATIONS
5C	1	WALL-MOUNTED WIRE SHELVES - 36"W	SERV-WARE	14 INCHES DEEP x 36 INCHES WIDE	TENANT	GC														SEE PLANS AND INTERIOR ELEVATIONS
6	1	REFRIG. CHEFBASE - 48"W	SERV-WARE	CB48-HC	TENANT	GC	EC	115	1	6	1/4									NEMA 5-15P
6A	1	REFRIG. CHEFBASE - 36"W	SERV-WARE	CB36-HC	TENANT	GC	EC	115	1	6	1/4									NEMA 5-15P
7	3	TRASH CAN	WINCO	PTCR-22G	TENANT	GC														
8	2	WARMING STATION	HATCO	MPWS-45	TENANT	GC	EC	120/208	1	14.3										NEMA L14-20P
9	2	WORKTOP FREEZER	TRUE	TWT-48	TENANT	GC	EC	115	1	3	1/5									NEMA 5-15P
11	2	STEAMER	ANTUNES	DFWF 250 (9100146)	TENANT	GC	PC/EC	208	1	15.9					1/4"					REQUIRES WATER LINE & PRESSURE REGULATOR - NEMA 6-20P
12	2	COOKER/WARMER	HATCO	BY TENANT	TENANT	GC	EC	120	1	15.0										NEMA 5-15P
13	2	REFRIG. PREPBOX - 60"W	TRUE	TSSU 6024-MBD-SST-HC	TENANT	GC	EC	115	1	6.5	1/2									NEMA 5-15P
14A	7	MONITOR			TENANT	VENDOR	EC	120	1	-										PROVIDED BY HOME OFFICE - VERIFY MODEL W/ OWNER
14B	5	BUMPBAR			TENANT	VENDOR	EC	120	1	-										PROVIDED BY HOME OFFICE - VERIFY MODEL W/ OWNER
14C	9	PRINTER			TENANT	VENDOR	EC	120	1	-										PROVIDED BY HOME OFFICE - VERIFY MODEL W/ OWNER
16	2	HOOD SYSTEM	CAPTIVEAIRE	SEE HOOD DWGS.	TENANT	GC	MC/EC	120	1	-										HOOD W/ ANSUL SYSTEM
17	1	REFRIG. PREPBOX - 36"W	BEVERAGE AIR	UCR34HC	TENANT	GC	EC	115	1	2.0	1/8									NEMA 5-15P
18	1	REFRIG. PREPBOX	TRUE	TSSU 60-08-HC	TENANT	GC	EC	115	1	6.5	1/3									NEMA 5-15P
19	2	MIX-IN BLENDER	CUSTOM	7"W X 24"H X 10"D	TENANT	GC	EC	115	1	2.1	3/4									NEMA 5-15P
20	1	COOKER/WARMER	NEMCO	6120A-CW	TENANT	GC	EC	120	1	8.3										NEMA 5-15P
21	2	DIPPER WELL	NEMCO	77316-10A	TENANT	GC	PC						1/4"				1" I.D.			
22	2	DIPPING CABINET	EXCELLENCE INDUSTRIES	FT-4	TENANT	GC	EC	115	1	1.4	1/8									NEMA 5-15P
24	1	FROZEN CUSTARD MACHINE	STOELTING	CF101-38B	TENANT	GC	EC	208	1	15.0	1 1/2									HEAT OUTPUT - 6,000 BTU/HR
24T	1	OPTIONAL FROZEN CUSTARD MACHINE	TAYLOR	CO02	TENANT	GC	EC	208	1	24/22	(2) 2									HEAT OUTPUT - 6,000 BTU/HR
25	1	EQUIPMENT STAND	SERV-WARE	ESS3024W-CWP	TENANT	GC														
26	2	SODA MACHINE	PEPSI	CB-2323	TENANT	VENDOR	PC/EC	120	1	1.0			3/8"				3/4"			PROVIDED BY VENDOR REQUIRE WATER w/SHUTOFF - PLEASE INDIRECT DRAIN CONNECTION AT NEAREST FLOOR SINK.
27	2	CUP DISPENSER	SAN JAMAR	CB503WF	TENANT	GC														
28	1	ELEC. JUICE DISPENSER	HAMILTON BEACH	HCJ967	TENANT	GC	EC	120	1	3.0										
29	2	JUICER	NEMCO	EASY JUICER 55850	TENANT	GC														
30	4	3-GAL DRINK DISPENSER	TABLECRAFT	1055	TENANT	GC														
31	1	1-GALLON WATER PITCHER	RUBBERMAID		TENANT	GC														PITCHER W/ LID
32	2	WALL-MOUNTED BIB KETCHUP DISPENSER	RED GOLD	SB0901	TENANT	GC	GC													
33	1	COFFEE/TEA BREWER	BUNN	ITCB-DV	TENANT	GC	PC/EC	120	1	14.0			1/4"							NEMA 5-15P. 1/4" C.W. MALE FLARE. REQUIRES 20-90 PS & 1 GPM WATER FLOW.
33B	1	COFFEE BREWER	BUNN	AX10MDV-3 (38700.00008)	TENANT	GC	PC/EC	120	1	15			1/4"							
34	1	SS TABLE w/ SHELF BELOW 24"x30"	SERV-WARE	T2430CWP-4	TENANT	GC														
34A	2	SS TABLE W/ SHELF BELOW 24"x36"	SERV-WARE	T2436CWP-4	TENANT	GC														
34B	1	SS TABLE w/ SHELF BELOW 24"x48"	SERV-WARE	T2448CWP-4	TENANT	GC														
34C	3	SS TABLE W/ SHELF BELOW 30"x36"	SERV-WARE	T3036CWP-4	TENANT	GC														
34F	1	SS TABLE w/ SHELF BELOW 18"x36"	SERV-WARE	T1836CWP-4	TENANT	GC														
34H	3	SS TABLE w/ SHELF BELOW 18"x60"	SERV-WARE	T1860CWP-4	TENANT	GC														
34P	1	14"x 24" PASS-THRU SHELF	STAINLESS STEEL FABRICATOR	14"DP x 24"W x 18"H (INSIDE FRAME)	TENANT	GC														
35	4	POS TERMINAL SYSTEM	SAM-4S	SPT-7000	TENANT	VENDOR	EC	120	1	.37										PROVIDED BY HOME OFFICE - NEMA 5-15P
35A	1	DROP SAFE - UNDERCOUNTER	LOOMIS	TITAN Z	TENANT	GC	EC	120	1	-										VERIFY MODEL W/ OWNER
36A	2	STORAGE RACK - 24x48	SERV-WARE	24"D X 48"W X 72"H	TENANT	GC														VERIFY MODEL W/ OWNER
36D	5	STORAGE RACK - 24x72	SERV-WARE	24"D X 66"W X 72"H	TENANT	GC														VERIFY MODEL W/ OWNER
36E	2	STORAGE RACK - 18x48	SERV-WARE	18"D X 48"W X 72"H	TENANT	GC														VERIFY MODEL W/ OWNER
36F	9	F/C STORAGE RACK - 18x48	SERV-WARE	18"D X 48"W X 72"H	TENANT	GC														VERIFY MODEL W/ OWNER
37	1	VEGGIE SINK W/ RH DRAIN	SERV-WARE	E1CWP1818L-24	TENANT	GC	PC						1/2"		1/2"		1.5" I.D.			SPLASHBOARD LEFT SIDE
38	1	3-COMPARTMENT SINK	SERV-WARE	D3CWP18182-18	TENANT	GC	PC						1/2"		1/2"		(3)1.5"			SPLASHBOARDS ON BOTH SIDES
39A	1	WALL-MOUNTED WIRE SHELVES - 48"W	SERV-WARE	48 INCHES WIDE	TENANT	GC														SEE PLANS AND INTERIOR ELEVATIONS
39B	4	WALL-MOUNTED WIRE SHELVES - 36"W	SERV-WARE	36 INCHES WIDE	TENANT	GC														SEE PLANS AND INTERIOR ELEVATIONS
39C	2	WALL-MOUNTED WIRE SHELVES - 24"W	SERV-WARE	24 INCHES WIDE	TENANT	GC														SEE PLANS AND INTERIOR ELEVATIONS
41	1	CAN WASH	FIAT	SB3636	TENANT	GC	PC											3"		
42	1	MODULAR BIB RACK	PEPSI	TAPRITE FASSCO	TENANT	VENDOR	EC/PC	120	1	1.5										PROVIDED BY VENDOR - AMPS FOR CARBONATOR
43	1	CO2 TANK	NUCO2		TENANT	VENDOR	EC													VERIFY MODEL W/ OWNER. PROVIDED BY VENDOR
44	1	BREAD RACK	FRANKLIN/FLOWERS	RT1 ROLL TRAY	TENANT	VENDOR														PROVIDED BY VENDOR
46	2	ICE MACHINE W/ FLAKER HEAD	HOSHIZAKI	F-801MAJ	TENANT	GC	EC	115	1	11.8										NEMA 5-15P. 3/8 OD SUPPLY & 3/4" INDIRECT DRAIN CONNECTION. 22"W X 27 3/8"D X 26"H
46A	1	ICE BIN - 1500LB	HOSHIZAKI	B-1500SS	TENANT	GC	PC/EC										3/4"			3/4" INDIRECT DRAIN CONNECTION. 48"W X 32 1/2"D
47A	1	OUTSIDE WALK-IN DRY STORAGE	NORLAKE	FINELINE	TENANT	GC	EC													SLOPED ROOF W/TAPERED INSULATION & FACTORY PRIMED EXTERIOR WALLS - SEE ARCH. SHEETS FOR LAYOUT, SLOPE DIRECTION & FINISHES
47C	1	OUTSIDE WALK-IN COOLER (BUILT w/ #47F)	NORLAKE	FINELINE	TENANT	GC	RC/MC/EC	208	3/1	5/2.9										SLOPED ROOF W/TAPERED INSULATION & FACTORY PRIMED EXTERIOR WALLS - SEE ARCH. SHEETS FOR LAYOUT, SLOPE DIRECTION & FINISHES.
47F	1	OUTSIDE WALK-IN FREEZER (BUILT w/ #47C)	NORLAKE	FINELINE	TENANT	GC	RC/MC/EC	208	3/1	5/2.9										SLOPED ROOF W/TAPERED INSULATION & FACTORY PRIMED EXTERIOR WALLS - SEE ARCH. SHEETS FOR LAYOUT, SLOPE DIRECTION & FINISHES
48	1	2-DOOR COOLER	SERV-WARE	RR-2-HC	TENANT	GC	EC	115	1	9	1/2									NEMA 5-15P. 82.3"H X 54"W X 33"D
50	1	USED OIL CONTAINER	VALLEY PROTEIN	VP EZ UCO	TENANT	VENDOR														PROVIDED BY VENOR.
51	1	CAN OPENER	WINCO	CO3	TENANT	GC														BAR LENGTH 12"
52	1	EMPLOYEE CUBBIES			TENANT	GC														BUILT BY CONTRACTOR
53	2	SHELF 48"W X 12"D - MNTO TO #9			TENANT	GC														VERIFY MODEL W/ OWNER. 48"W X 12"D (MOUNTS TO BACK OF WORKTOP 9)
54	1	TOASTER - 4 SLOT	HATCO	TPT-120	TENANT	GC	EC	120	1	15.0										NEMA 5-15P

LHMT Project No. 21318

THIS DRAWING IS THE PROPERTY OF THE ARCHITECT AND MAY NOT BE REPRODUCED OR USED WITHOUT THE WRITTEN PERMISSION.

national restaurant designers

ARCHITECTS & ENGINEERS

7208 ACC Blvd. second floor, Raleigh, NC 27617
ph: 919 544 0087 fax: 919 544 9399

BRIAN L. JONES

REGISTERED ARCHITECT

No.9372

NORTH CAROLINA

Digitally signed by Brian Jones
Date: 2022.06.24 16:59:47 -04'00'

PROJECT: **HIGHWAY 55**
30 PROTOTYPE

1424 CURTIS BRIDGE ROAD
WILKESBORO, NC 28697

DRAWING: EQUIPMENT SCHEDULE

Revisions

THRU ADDENDUM "A"

01/20/2022

EQUIP. UPDATE - 06.24.2022

PROJECT DATE
01/07/2022

Drawn By
MTP/CDK

Checked By
NRD

Sheet No.
Q600

NEW KITCHEN EQUIPMENT SCHEDULE																				
GENERAL								ELECTRICAL				PLUMBING								
ITEM	QTY.	DESCRIPTION	MANUFACTURER	SIZE/MODEL NUMBER	FURN. BY	INST. BY	CONN. BY	VOLT	PHASE	AMPS	HP	ROUGH-IN HEIGHT	CW	HW (110")	HW (140")	SUPPLY PIPING ROUGH-IN HEIGHT	DRAIN SIZE	DRAIN PIPING ROUGH-IN HT.	QAS/BTU	REMARKS
55	1	WATER FILTRATION SYS. w/BOOSTER PUMP	ANTUNES	VZN-411V	TENANT	GC	EC	120	1	0.08			3/4"							
56	1	MOVABLE RACK SYSTEM	BY TENANT	14'-0" LONG TRACK	TENANT	GC														
57	1	CONVECTION OVEN	WINCO	ECO-500	TENANT	GC	EC	120	1	13.3										CORD AND PLUG
59	3	HALF HEIGHT STORAGE RACK - 18x36	SERV-WARE	18"D X 36"W X 36"H	TENANT	GC														VERIFY MODEL W/ OWNER
59A	2	HALF HEIGHT STORAGE RACK - 18x48	SERV-WARE	18"D X 48"W X 36"H	TENANT	GC														VERIFY MODEL W/ OWNER
60	1	BISCUIT RACK			TENANT	GC														VERIFY W/ OWNER
62	1	SERVICE SINK FAUCET	T&S BRASS	B-0655-BSTR	TENANT	GC	PC						1/2"		1/2"					
63	1	UTILITY SHELF MOP RACK	ADVANCE TABCO	K-245-X	TENANT	GC														
65	2	ELECTRIC 12" CLAMSHELL GRILL	GARLAND	XPE12	TENANT	GC	EC	208	3	26.2										NEMA 15-50 (2)
65D	1	OPTIONAL ELECTRIC 24" CLAMSHELL GRILL	GARLAND	XPE24	TENANT	GC	EC	208	3	52.4										NEMA 15-50 (2)
80	5	BAR STOOL			TENANT	GC														
81	4	DINING CHAIRS			TENANT	GC														
81A	12	HI-TOP CHAIRS			TENANT	GC														
82H	2	2 SEAT HI-TOP TABLE			TENANT	GC														
82HC	2	ADA TABLE - 30"x48"			TENANT	GC														
83	2	BOOTH BENCH 48" - END			TENANT	GC														
83A	2	BOOTH BENCH 60" - END			TENANT	GC														
84	2	BOOTH BENCH 48" - DOUBLE			TENANT	GC														
84A	4	BOOTH BENCH 60" - DOUBLE			TENANT	GC														
85	2	BOOTH TABLE - 30"x48"			TENANT	GC														
85A	5	BOOTH TABLE - 30"x60"			TENANT	GC														
85H	2	4 SEAT HI-TOP TABLE - 30"x48"			TENANT	GC														
86	26	OUTDOOR CHAIRS			TENANT	GC														
87	2	OUTDOOR TABLE 30"x48"			TENANT	GC														
87A	3	OUTDOOR TABLE 36" ROUND			TENANT	GC														
87AHC	1	OUTDOOR TABLE 36" ROUND ADA			TENANT	GC														
87HC	1	OUTDOOR TABLE 30"x48" - ADA			TENANT	GC														
89	2	DEDICATED HOLDING CABINET	PRINCE CASTLE	DHB2PT-20B	TENANT	GC	EC	120	1	10										NEMA 5-20P
90	1	SEMI RECESSED FIRE EXTINGUISHER		ABC CLASS	TENANT	GC														
90A	2	FIRE EXTINGUISHER		ABC CLASS	TENANT	GC														
90B	1	FIRE EXTINGUISHER		K CLASS	TENANT	GC														
91	1	AIR CURTAIN	SEE MECHANICAL SHTS		TENANT	GC	MC/EC	120	1	5.1										SEE MECHANICAL
92	2	INSTANTANEOUS WATER HEATER PACKAGE	NORITZ	NCC199CDV	TENANT	GC	PC/EC	120	1	59W			3/4"		3/4"				3/4" NPT - 199,000 BTU/HR	SEE PLUMBING
93	1	MANAGERS DESK/ SHELIVING UNIT	SERV-WARE	24"D X 48"W X 72"H	TENANT	GC														PROVIDE SOLID S.S. TOP @ 34" AFF WITH SHELVES ABOVE - VERIFY MODEL W/ OWNER
94	1	IT EQUIPMENT SHELIVING UNIT	SERV-WARE	24"D X 48"W X 72"H	TENANT	GC														PROVIDE POWER FOR POS EQUIPMENT- VERIFY MODEL W/ OWNER
95	1	WALL MOUNTED CONDIMENTS	BY TENANT	BY TENANT	TENANT	GC														
96	2	PUBLIC TRASH BIN	BY TENANT		TENANT	GC														
97	1	TO GO RACK	BY TENANT	12"x48"	TENANT	GC														
98	2	DUNNAGE RACK - 24x48	SERV-WARE	24"D X 48"W X 12"H	TENANT	GC														VERIFY MODEL W/ OWNER
99	2	SERV. ROBOT	BEAR ROBOTICS	SERV. MODEL	TENANT	GC		110	1	3.5										PROVIDE WALL OUTLET FOR RE-CHARGING

2

2

1

2

2

1

3

2

LMHT Project No. 21318

THIS DRAWING IS THE PROPERTY OF THE ARCHITECT AND MAY NOT BE REPRODUCED OR USED WITHOUT THE WRITTEN PERMISSION

national restaurant designers

ARCHITECTS & ENGINEERS

7208 ACC Blvd. second floor, Raleigh, NC 27617
ph: 919 544 0087 fax: 919 544 9399

BRIAN L. JONES

REGISTERED ARCHITECT

No.9372

NORTH CAROLINA

11/11/22

PROJECT: **HIGHWAY 55**

30 PROTOTYPE

1424 CURTIS BRIDGE ROAD
WILKESBORO, NC 28697

DRAWING: EQUIPMENT SCHEDULE

Revisions

THRU ADDENDUM "A"
01/20/2022

ADDENDUM "A" - 02/06/2022

EQUIP. UPDATE - 06.24.2022

CLARIFICATIONS - 11.11.2022

PROJECT DATE
01/07/2022

Drawn By
MTP/CDK

Checked By
NRD

Sheet No.
Q601