

RECORD OF SURVEY NO. 32 - 67

SHEET 1 OF 2

IN THE UNINCORPORATED TERRITORY OF MONO COUNTY, STATE OF CALIFORNIA

BEING A PORTION OF THE NORTHWEST QUARTER OF THE SOUTHEAST QUARTER OF SECTION 33, TOWNSHIP 5 NORTH, RANGE 25 EAST, M.D.B.&M. MORE PARTICULARLY DESCRIBED AS LOTS 12, 13, 14, 15, 24, 25 AND GRANT DEED VOL 43, PAGE 231 OF TOWN OF BRIDGEPORT RECORDED IN MAP BOOK 1 AT PAGE 61 OF OFFICIAL RECORDS ON FILE IN THE OFFICE OF THE COUNTY RECORDER OF SAID COUNTY.

SURVEYOR'S STATEMENT:

THIS MAP CORRECTLY REPRESENTS A SURVEY MADE BY ME OR UNDER MY DIRECTION IN CONFORMANCE WITH THE REQUIREMENTS OF THE PROFESSIONAL LAND SURVEYOR'S ACT AT THE REQUEST OF ANN VERNON AND VINCENT FRICK IN MAY, 2007.

DAVID LAVERTY DATE 7/7/08
L.S. 4587 LIC. EXP. 9-30-08

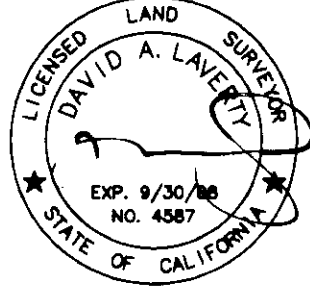
**COUNTY SURVEYOR'S STATEMENT:**

THIS MAP HAS BEEN EXAMINED IN ACCORDANCE WITH SECTION 8766 OF THE PROFESSIONAL LAND SURVEYOR'S ACT THIS 15th DAY OF July 2008.

MONO COUNTY SURVEYOR

John S. Parrish DATE 07-15-08
JOHN S. PARRISH
LIC. NO. 5050 LIC. EXP. 6-30-10

**RECORDER'S STATEMENT:**

INSTRUMENT NO. : 2008003608
FEE : \$11.00

FILED THIS 18th DAY OF JULY 2008,
AT 9:50 A.M. IN BOOK 4 OF RECORD OF
SURVEY MAPS AT PAGES 35-35A AT THE REQUEST
OF VINCENT FRICK

LYNDA ROBERTS
MONO COUNTY RECORDER

BY : Dena Vandeballe
DEPUTY COUNTY RECORDER

PURPOSE OF SURVEY

THE REASON FOR THIS RECORD OF SURVEY IS AS SET FORTH IN THE PROFESSIONAL LAND SURVEYOR'S ACT, ARTICLE 5, 8762(b)(5): THE POINTS OR LINES SET DURING THE PERFORMANCE OF A FIELD SURVEY OF ANY PARCEL DESCRIBED IN ANY DEED OR OTHER INSTRUMENT OF TITLE RECORDED IN THE COUNTY RECORDER'S OFFICE ARE NOT SHOWN ON ANY SUBDIVISION MAP, OFFICIAL MAP, OR RECORD OF SURVEY.

LEGEND:

• FOUND MONUMENT AS NOTED

(M) MEASURED

(C) CALCULATED

IP IRON PIPE

FND FOUND

RECORD INFORMATION:

RECORD INFORMATION SEE SHEET 2

