

**CORNER RECORD  
UNINCORPORATED**

Bk24 Pg. 1  
Document Number CR 2698  
County of **ALAMEDA**, California

City of \_\_\_\_\_  
Brief Legal Description **EAST LINE OF PARCEL B, PARCEL MAP NO. 1141, FILED JULY 27, 1973 (79 MAPS 96)**

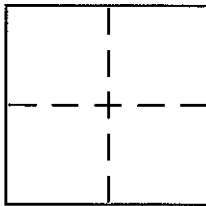

**CORNER TYPE**

Government Corner ☐ Control ☐  
Meander ☐ Property ☒  
Rancho ☐ Other ☐  
Date of Survey MAY 4, 2006

**COORDINATES (Optional)**

N. \_\_\_\_\_  
E. \_\_\_\_\_  
Zone \_\_\_\_\_ NAD27 ☐ NAD83 ☐  
NAD83 Epoch \_\_\_\_\_  
Elev. \_\_\_\_\_  
Vert. Datum: NGVD29 ☐ NAVD88 ☐  
Meas. Units: Metric ☐ Imperial ☐

Corner – Left as found ☐ Found and tagged ☐ Established ☒ Reestablished ☒ Rebuilt ☐

Identification and type of corner found: Evidence used to identify or procedure used to establish or reestablish the corner:  
**FOUND STANDARD COUNTY PIN MONUMENTS IN WELL ON CENTERLINE OF KELLY STREET WESTERLY OF MAUD AVENUE, AS SHOWN ON PARCEL MAP NO. 1141 (79 MAPS 96), AND ON CENTERLINE OF MAUD AVENUE, AS SHOWN ON TRACT MAP 5637 (175 MAPS 63).**

SEE SKETCH ON PAGE 2 OF 2.

A description of the physical condition of the monument as found and as set or reset:

**FOUND: 3/4" IRON PIPE WITH BRASS TAG "RCE 7996 / LS 2578", AS SHOWN ON PARCEL MAP NO. 1141**

**SET: CONCRETE NAIL AND 3/4" BRASS TAG "PLS7393" IN CONCRETE HEADWALL, ON EASTERLY PROPERTY LINE, 78.50' NORTHERLY FROM THE SOUTHEAST CORNER OF PARCEL B (79 MAPS 96).**

SEE SKETCH ON PAGE 2 OF 2.

**SURVEYOR'S STATEMENT**

This Corner Record was prepared by me or under my direction in conformance with  
the Land Surveyor's Act on MAY 8, 2006

Signed Keith Nofield P.L.S. or R.C.E. No. PLS 7393

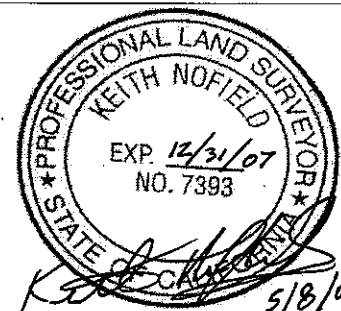

**COUNTY SURVEYOR'S STATEMENT**

This Corner Record was received 5-16-06

and examined and filed 6-14-06

Signed Russell R. Penland P.L.S. or R.C.E. No. 5726

Title COUNTY SURVEYOR

County Surveyor's Comment \_\_\_\_\_

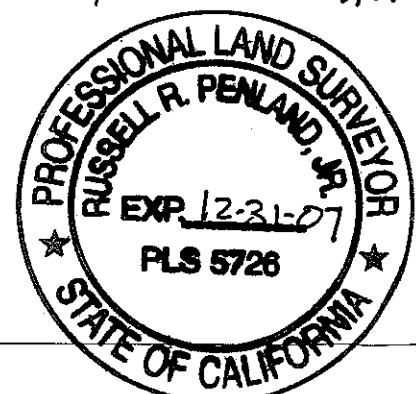

SCALE IN FEET

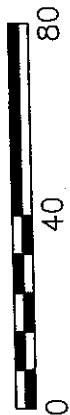

SCALE: 1" = 40'



**PARCEL B**  
PM 1141  
(79 MAPS 96)

2764 KELLY ST  
417-070-050

SET CONCRETE NAIL &  
3/4" TAG "PLS 7393"  
IN CONCRETE HEADWALL

2772 KELLY ST  
417-070-020

FD. 3/4" I.P. & TAG  
"RCE 7996 / LS 2578"  
PER PM 1141 (79 MAPS 96)

85.00'  
N 84°15'00" E  
30.03'  
N 84°15'00" E  
198.41'  
N 84°15'16" E  
779.76' (CALC'D & MEAS.)

801.98' (PM 1141)  
801.95' (PM 5892)

**KELLY STREET**  
CO. ROAD NO. 2042

STANDARD COUNTY  
PIN MONUMENT  
IN WELL (TYPICAL)

30'

233.94'

WOODROE AVENUE

KELLY ST

MAUD AVENUE

WOODROE AVE

KELLY ST

10.00'  
SNF

N 84°15'00" E  
801.95' (PM 5892)

25.93'  
33.26'

9.02'  
N 84°51'16" E  
779.76'

MAUD AVE  
N 29°57'55" W

### REFERENCES

PARCEL MAP 1141 (79 MAPS 96)  
TRACT MAP 5637 (175 MAPS 64)  
PARCEL MAP 5892 (208 MAPS 47)