

EXHAUST FAN INFORMATION – JOB#5343821

FAN UNIT NO	TAG	QTY	FAN UNIT MODEL #	MANUFACTURER	CFM	ESP	RPM	MOTOR ENCL	HP	BHP	PHASE	VOLT	FLA	DISCHARGE VELOCITY	WEIGHT (LBS)	SDNES
1		1	DU180HFA	CAPTIVEAIRE	3100	1.347	1283	ODP,PREMIUM	3.000	1.5170	3	208	9.5	716 FPM	189	18.9
2		1	DU180HFA	CAPTIVEAIRE	3100	1.347	1283	ODP,PREMIUM	3.000	1.5170	3	208	9.5	716 FPM	189	18.9
3		1	DR12HFA	CAPTIVEAIRE	450	0.250	1220	TEAO-ECM	0.250	0.0810	1	115	2.9		49	6.4

CONDENSER DETAILS

FAN UNIT NO	TAG	FAN UNIT MODEL #	CONDENSER NO	TONNAGE	VOLTAGE	PHASE	FREQUENCY	MCA	RLA	MAX FUSE SIZE	MIN WIRE SIZE	SEER
4		A3-D.500-24D-MPU	1	5	208-230	3 PHASE	60 HZ	21.4 AMPS	17.4 AMPS	30 AMPS	10 AWG	14
			2	5	208-230	3 PHASE	60 HZ	21.4 AMPS	17.4 AMPS	30 AMPS	10 AWG	14

MUA FAN INFORMATION – JOB#5343821

FAN UNIT NO	TAG	QTY	FAN UNIT MODEL #	BLOWER	HOUSING	MIN CFM	DESIGN CFM	ESP	RPM	MOTOR ENCL	HP	BHP	PHASE	VOLT	FLA	MCA	MDCP	WEIGHT (LBS)	SDNES
4		1	A3-D.500-24D-MPU	24MF-3-MDD	A3-D.500	3600	4960	0.900	1433	ODP,PREMIUM	7.500	5.0010	3	208	211	27.6A	45A	1925	14.5

COILS – JOB#5343821

FAN UNIT NO	TAG	COIL TYPE	DESIGN CFM	COOLING										HEATING									
				ENTERING DB TEMP	ENTERING WB TEMP	LEAVING DB TEMP	LEAVING WB TEMP	ENTERING FLUID TEMP	LEAVING FLUID TEMP	FLUID FLOW RATE	PERCENT GLYCOL	TOTAL CAPACITY	SENSIBLE CAPACITY	LATENT CAPACITY	ENTERING DB TEMP	LEAVING DB TEMP	ENTERING FLUID TEMP	LEAVING FLUID TEMP	FLUID FLOW RATE	PERCENT GLYCOL	STEAM PRESSURE	TOTAL CAPACITY	SENSIBLE CAPACITY
4		DX	4960	95.0°F	78.0°F	81.9°F	71.9°F	---	---	---	---	120.0 MBH	68.1 MBH	51.9 MBH	---	---	---	---	---	---	---	---	---

CAS FIRED MAKE-UP AIR UNIT(S)

FAN UNIT NO	TAG	INPUT BTUs	OUTPUT BTUs	TEMP RISE	REQUIRED INPUT GAS PRESSURE	GAS TYPE	BURNER EFFICIENCY(%)
4		531262	488761	100°F	7 IN. W.C. – 14 IN. W.C.	NATURAL	92

FAN OPTIONS

FAN UNIT NO	TAG	QTY	DESCRIPTION
1		1	GREASE BOX
		1	UPBLAST FAN WHEEL ACCESS PORT
		1	FAN BASE CERAMIC SEAL – INSTALLED AT PLANT – FOR GREASE DUCTS
		1	2 YEAR PARTS WARRANTY
2		1	GREASE BOX
		1	UPBLAST FAN WHEEL ACCESS PORT
		1	FAN BASE CERAMIC SEAL – INSTALLED AT PLANT – FOR GREASE DUCTS
		1	2 YEAR PARTS WARRANTY
3		1	ECM WIRING PACKAGE – MANUAL OR 0-10VDC REFERENCE SPEED CONTROL (TELCO MOTOR), CCW ROTATION
		1	I 12-BDD DAMPER
		1	2 YEAR PARTS WARRANTY
		1	INLET PRESSURE GAUGE, 0-35"
4		1	MANIFOLD PRESSURE GAUGE, -5 TO 15" WC
		1	MOTORIZED BACKDRAFT DAMPER FOR A3-D HOUSING – MEETS AMCA CLASS 1A RATING
		1	10 TON 2 CIRCUIT (5/5) MODULAR PACKAGED COOLING OPTION FOR SIZE 3 DF/EH MUA (3,600 TO 6,000 CFM), 208V/230V, 3 PHASE, COOLING THERMOSTAT OR PROGRAMMABLE STAT REQUIRED FOR PROPER OPERATION
		1	DOWNTURN PLENUM FOR SIZE 3 DX COIL MODULE
		1	SHIP CONDENSERS LOOSE – TWO CONDENSERS, THREE PHASE – CONDENSER DISCONNECTS SHIPPED LOOSE
		1	FREEZE/STAT
		1	UNIT MOUNTED VFD FOR USE WITH ECM03
		1	2 YEAR PARTS WARRANTY

FAN ACCESSORIES

FAN UNIT NO	TAG	EXHAUST			SUPPLY			
		GREASE CUP	GRAVITY DAMPER	WALL MOUNT	SIDE DISCHARGE	GRAVITY DAMPER	MOTORIZED DAMPER	WALL MOUNT
1		YES						
2		YES						
3			YES					
4							YES	

CURB ASSEMBLIES

NO	DN FAN	WEIGHT	ITEM	SIZE
1	# 1	34 LBS	CURB	26.500"W X 26.500"L X 30.000"H ALONG LENGTH, RIGHT VENTED HINGED.
2	# 2	34 LBS	CURB	26.500"W X 26.500"L X 30.000"H ALONG LENGTH, RIGHT VENTED HINGED.
3	# 3	16 LBS	CURB	17.500"W X 17.500"L X 12.000"H ALONG LENGTH, RIGHT.
4	# 4	114 LBS	CURB	35.000"W X 84.000"L X 20.000"H ALONG WIDTH, RIGHT INSULATED.
	# 4		RAIL	6.000"W X 35.000"L X 20.000"H RIGHT.

NOTE: UNLESS OTHERWISE STATED, PANDA RESTAURANT GROUP SHALL PROVIDE ALL EQUIPMENT ON THE FOLLOWING CAPTIVEAIRE SHEETS, INCLUDING: HOODS, FIRE SYTEM, EXHAUST FANS, SUPPLY FAN, BATHROOM FAN AND ELECTRICAL INTERLOCK PACKAGE

DOUBLE WALL DUCT BY MECHANICAL PLEASE USE CONTACT BELOW FOR PRICING

ANSUL GAS VALVE:  
THE ANSUL GAS VALVE IS PROVIDED BY CAPTIVEAIRE SYSTEMS. CONTACT OUR OFFICE WITH THE VALVE SIZE 3 DAYS IN ADVANCE OF WHEN IT IS NEEDED ON SITE.

FOR QUESTIONS CALL THE CAPTIVEAIRE SOUTHERN CALIFORNIA OFFICE  
3002 DOW AVENUE, SUITE 410  
TUSTIN, CA 92780  
TEL: 714-957-1500 EMAIL: REG86@CAPTIVEAIRE.COM

FANS #1, #2 – DU180HFA EXHAUST FAN

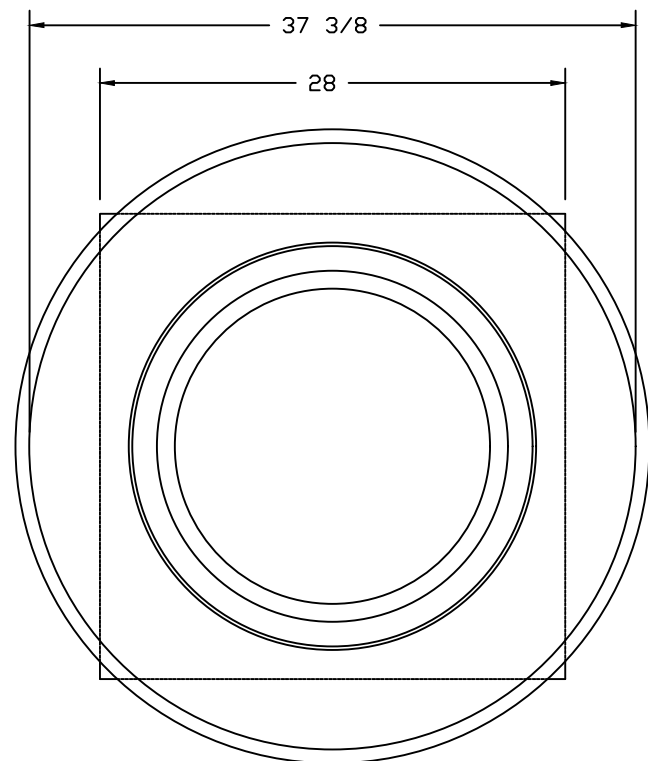
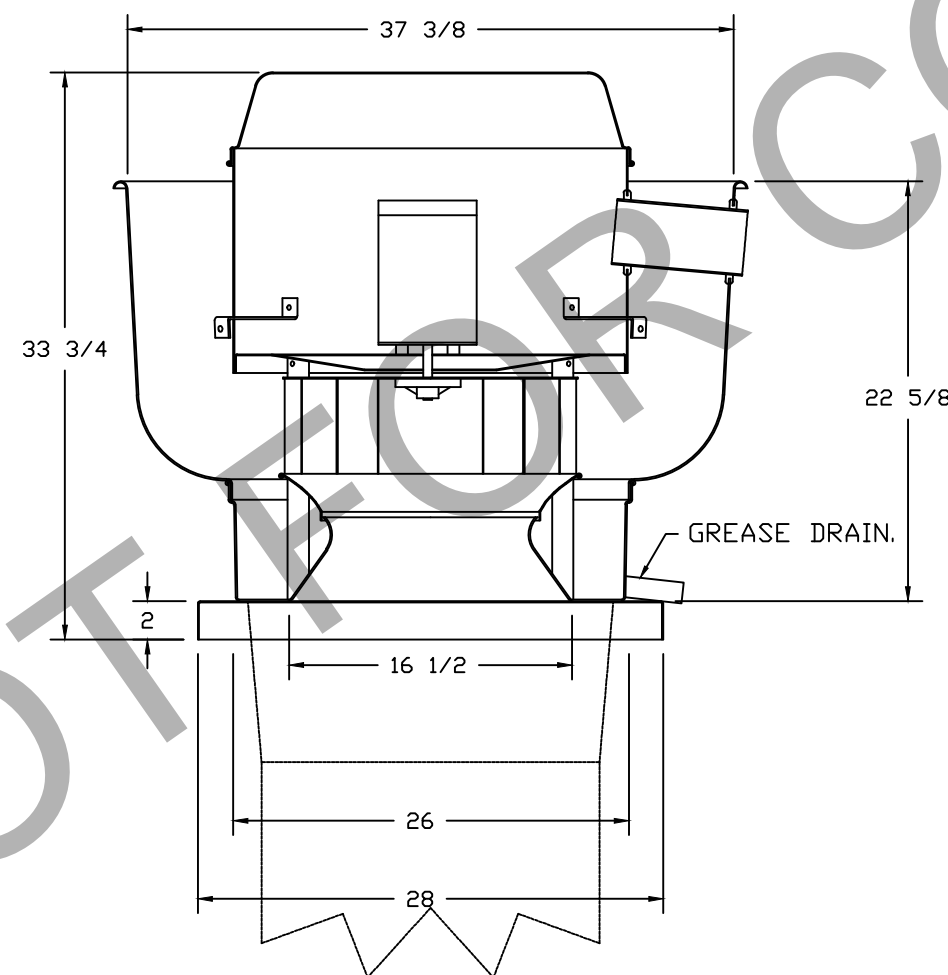

TOP VIEW

FEATURES:

- DIRECT DRIVE CONSTRUCTION (NO BELTS/PULLEYS).
- ROOF MOUNTED FANS.
- RESTAURANT MODEL.
- UL705 AND UL762 AND ULC-S645
- VARIABLE SPEED CONTROL.
- INTERNAL WIRING.
- THERMAL OVERLOAD PROTECTION (SINGLE PHASE).
- HIGH HEAT OPERATION 300°F (149°C).
- GREASE CLASSIFICATION TESTING.
- NEMA 3R SAFETY DISCONNECT SWITCH.

**NORMAL TEMPERATURE TEST**  
EXHAUST FAN MUST OPERATE CONTINUOUSLY WHILE EXHAUSTING AIR AT 300°F (149°C) UNTIL ALL FAN PARTS HAVE REACHED THERMAL EQUILIBRIUM, AND WITHOUT ANY DETERIORATING EFFECTS TO THE FAN WHICH WOULD CAUSE UNSAFE OPERATION.

**ABNORMAL FLARE-UP TEST**  
EXHAUST FAN MUST OPERATE CONTINUOUSLY WHILE EXHAUSTING BURNING GREASE VAPORS AT 600°F (316°C) FOR A PERIOD OF 15 MINUTES WITHOUT THE FAN BECOMING DAMAGED TO ANY EXTENT THAT COULD CAUSE AN UNSAFE CONDITION.

OPTIONS

GREASE BOX.  
UPBLAST FAN WHEEL ACCESS PORT.  
FAN BASE CERAMIC SEAL – INSTALLED AT PLANT – FOR GREASE DUCTS.  
2 YEAR PARTS WARRANTY.

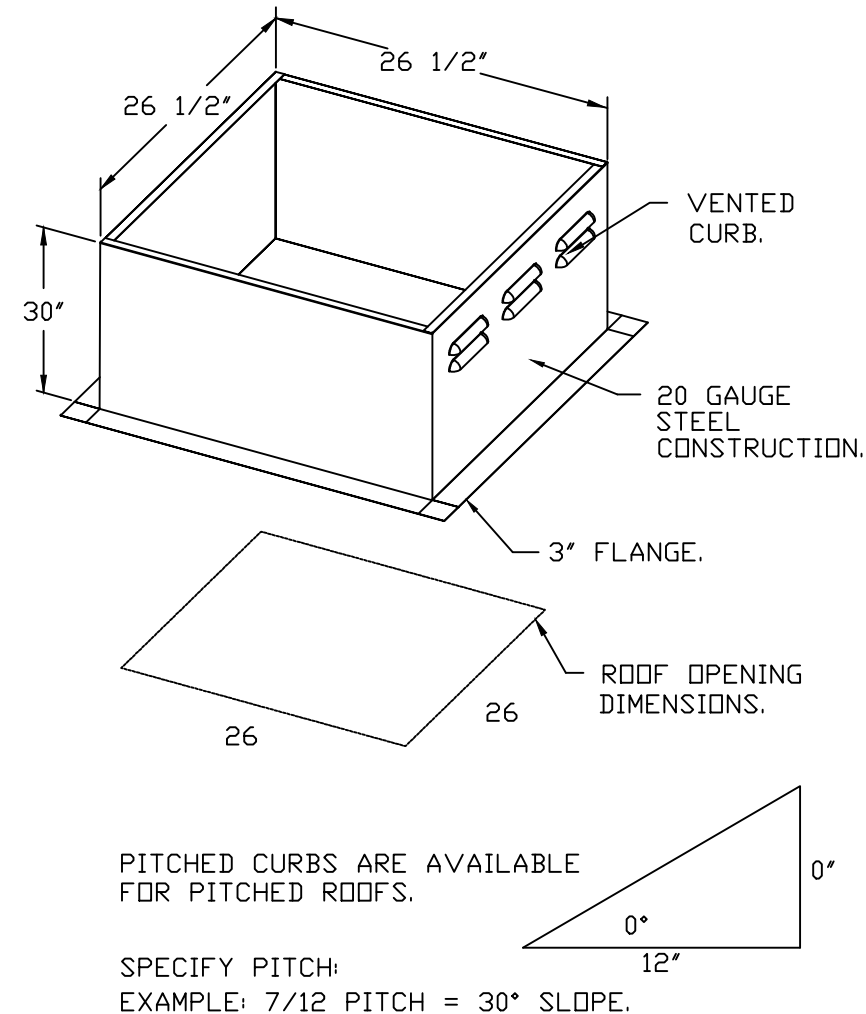

PITCHED CURBS ARE AVAILABLE FOR PITCHED ROOFS.

SPECIFY PITCH:  
EXAMPLE: 7/12 PITCH = 30° SLOPE.

REVISIONS

DESCRIPTION	DATE

CAPTIVEAIRE

Southern California Office

3002 Dow Ave., Suite 410, Tustin, CA 92780 PHONE: (714) 957-1500 FAX: (919) 227-5975 EMAIL: reg86@captiveaire.com

DATE: 2/23/2022

DWG.#: 5343821

DRAWN BY: AH-86

SCALE: 3/4" = 1'-0"

MASTER DRAWING

SHEET NO. 4



PANDA RESTAURANT GROUP INC.  
1683 Walnut Grove Ave.  
Rosemead, California  
91770  
Telephone: 626.799.9898  
Facsimile: 626.372.8288

All ideas, designs, arrangement and plans indicated or represented by this drawing are the property of Panda Express Inc. and were created for use on this specific project. None of these ideas, designs, arrangements or plans may be used by or disclosed to any person, firm, or corporation without the written permission of Panda Express Inc.

REVISIONS:

ISSUE DATE:

1 03.04.2022 ISSUE FOR PERMIT

DRAWN BY: SDT

PANDA PROJECT #: - S8-22-D8698  
C&P PROJECT #: - 2210806

CUHACI PETERSON

2600 Maitland Center Parkway  
Suite #200  
Maitland, FL 32751  
P (407) 661-9100  
F (407) 661-9101  
c-p.com

03.04.2022



PANDA EXPRESS  
TRUE WARM AND WELCOME 2200  
3030 DERITA ROAD  
CONCORD, NC 28027

M-403

HOOD DETAIL PLAN

TRUE WARM & WELCOME 2200 R4