

SECTION CORNER  
20 21  
29 28  
(334.11')<sup>2</sup>

### County Surveyor's Statement

This map has been examined in accordance with Section 8766 of the Professional Land Surveyors' Act this 19 day of July, 2017.

Mendocino County, State of California

By: Howard N. Dashiell  
Howard N. Dashiell, L. S. 7148  
County Surveyor  
License Expires 6/30/19

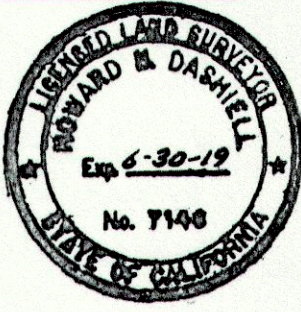

### County Recorder's Statement

Filed this 26<sup>th</sup> day of July, 20 17, at 9:16 A.M. in Maps, Drawer 86, Page 52, M. C. R. at the request of Forrest Francis.

Susan M. Ranochak  
County Recorder

Fee: \$9.00 By: Marianne Alvarez Deputy

### Basis of Bearings

The calculated bearing South 77° 23' 17" West, between found monuments being the southeast corner of the lands of Buffo as shown and delineated on that certain Record of Survey filed in Map Case 2, Drawer 39, Page 40, M.C.R. and the northeast corner of the lands of Roach as shown and delineated on that certain Record of Survey filed in Map Case 2, Drawer 25, Page 12, M.C.R. was used as the basis of bearings shown hereon.

### Legend

- ----- Dimensional point only
  - ----- Set 5/8" rebar w/plastic cap, LS 5121
  - ⊕ ----- Monument as described.
  - ( ) ----- Record Data per M.C. 2, Dr. 39, Pg. 40, M.C.R.
  - ( )<sup>2</sup> ----- Record Data per M.C. 2, Dr. 25, Pg. 12, M.C.R.
  - ( )<sup>3</sup> ----- Record Data per Inst. No. 2006-25132, M.C.R.
- Record data agrees with measured unless shown otherwise

### Surveyor's Statement

This map correctly represents a survey made by me or under my direction in conformance with the requirements of the Professional Land Surveyors' Act at the request of Ken Powell and Dana Price in June, 2017.

Forrest Neal Francis, L. S. 5121  
License Expires 6/30/19

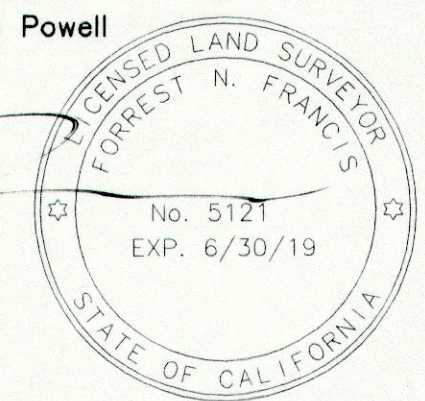

Prepared by:  
Forrest Francis, Land Surveyor  
P.O. Box 1162  
Mendocino, CA 95460  
(707)937-9900 / ffrancis@mcn.org

**RECORD OF SURVEY**  
Of a portion of Section 29, Township 19 North, Range 17 West, Mount Diablo Base and Meridian.

County of Mendocino, State of California  
Scale 1" = 50' June, 2017  
Sheet One of One

Serial #158 Job #17300

Maps
Drawer <u>86</u>
Page <u>52</u>

R.O.S. 29-2017